

wiper A60

seal spec

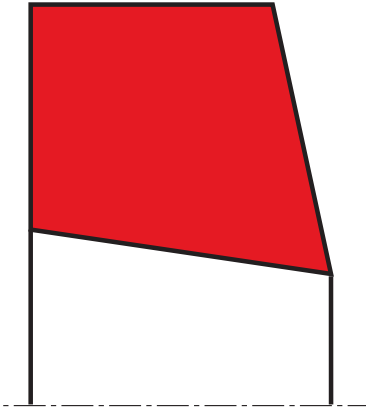

description

wiper with a sharply defined lip edge.

application



not bolded symbols; please consult our technical for application limitations

category of profile

machined or molded/standard/trade product.

single acting

area of application: hydraulics & pneumatics

hydraulic and pneumatic system, reciprocal movements, light dirt load.

function:

the A60 is a single function wiper. it is pressed against the descending piston rod wiping the dirt from the surface of the rod. the seals, their associated elements and the medium are protected from dirt. due to its compact design, it is recommended for low speeds.

media

hydraulic oils acc. DIN 51524/51525, lubricating oils, other mineral oil based fluids and HFA, HFB, HFC highly non-flammable hydraulic fluids acc. VDMA 24317.

operating parameters & material

material	temperature	max. surface speed
s-mart NBR (90 Shore A)	-40 °C ... +100 °C	0,5 m/s

the stated operation conditions represent general indications. it is recommended not to use all maximum values simultaneously. surface speed limits apply only to the presence of adequate lubrication film.

surface quality

surface roughness	Ra (µm)
sliding surface	according to seal data
bottom of groove	≤ 2.5
groove face	≤ 4.0

**tolerance recommendation**

seal housing tolerances	
D	H10
D1	H11

CS	R [mm]
≤ 5	max. 0,3
$>5,.....\leq 7,5$	max. 0,4
$>7,5,.....\leq 10$	max. 0,6
> 10	max. 0,8

fitting & installation

the wiper is built in to a semi-closed axial groove and due to its design, is particularly easy to install. the recess on the atmospheric side of the groove ensures good axial security in the housing.

seal & housing recommendations

please note that we are able to produce those profiles to your specific need or any non standard housing. for detail measurements, please see seal-mart catalog...

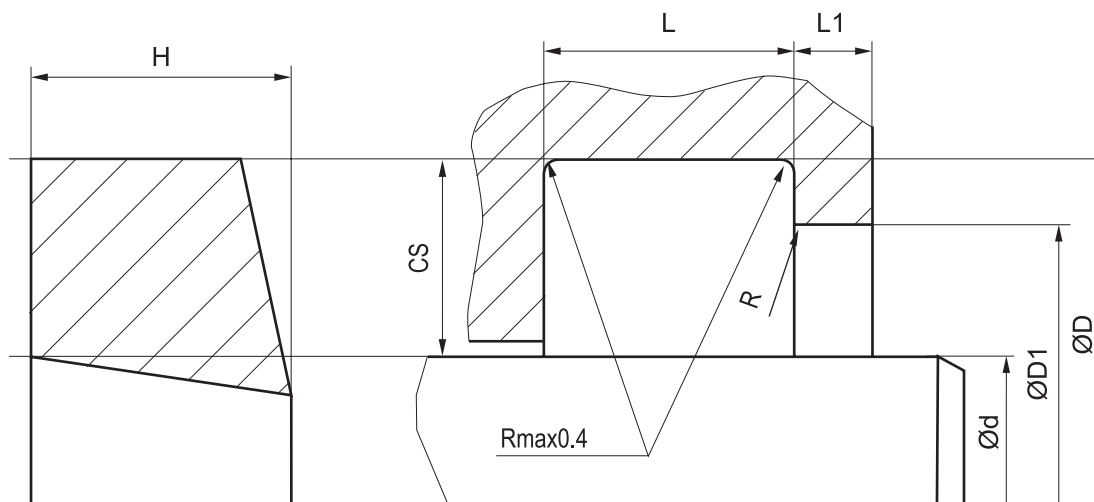

don't hesitate to contact our technical department for further information or for special requirements (temperature, speed etc.), so that suitable materials and/or designs can be recommended.